

RAVELLI

APGL5 Model Tripod



Product Overview

The Ravelli APGL5 is a Professional Quality Tripod providing a solid base for high-end photographic equipment. It is made from Aluminum to create a light weight and sturdy tripod. The ball head provides smooth adjustments to any angle. The center column is gearless and the legs can be inverted for low angle shots or compact storage.

Features

- Head
 - Quick Release Plate With Safety Locking Button
 - Professional Detachable Metal Ball Head
 - Smooth Pan & Tilt Dampened Motion
- Legs
 - 2 Step Locking Positions, Including inverted
 - Quick Twist Leg Lock Height Adjustments
 - Padded Foam Grips On Two Of The Legs To Safely Grab and Transport Your Tripod
 - Non-Slip Rubber Feet For a Stable Tripod
- Other
 - Compact and Light, Yet Still Supports Cameras Up To 17 LBS
 - Height Adjustable Center Column
 - Accessory hook



Identifying the parts



- A Quick Release Plate
- B Quick Release Safety Button
- C Quick Release Plate Knob
- D Ballhead Adjustment Knob
- E Ballhead Panning Adjustment Knob
- F Center Column Height Adjustment Lock
- G Push Button Leg Locks
- H Foam Handle Grips
- I Height Adjustment Twist Leg Locks
- J Rubber Feet
- K Accessory hook

Using the Tripod

Initial Set UP

To begin using the tripod, open the carrying bag using the zipper and pull the tripod out of the protective plastic bag. The tripod is stored in the inverted position. Invert each leg and adjust the center column.

Height Adjustment

Adjusting the height of the Ravelli APGL5 Tripod can be done by simply twisting the rubber knobs located on the legs, clockwise to lock or counter-clockwise to unlock. Then extend the legs down to the desired height, and relock the rubber knobs. *(Note: When adjusting height, try to extend the thicker leg segment, as they are thicker and provide greater stability.)* If after you have fully extended the legs, you have still not reached the maximum operating height, you may adjust the center column up.

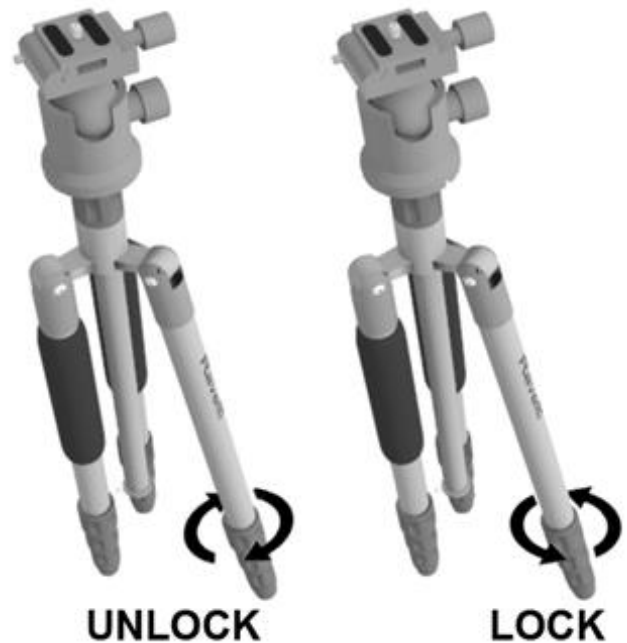

Quick Tip: You can unlock all segments on each leg at once by grabbing them at the same time and then twisting counter clockwise to unlock. Extend the legs then lock each knob. To quickly retract the legs when they are extended, unlock each knob on one leg starting with the thicker portion of the leg, retract the leg then tighten all knobs with one hand turning clockwise.

The Quick Release Plate

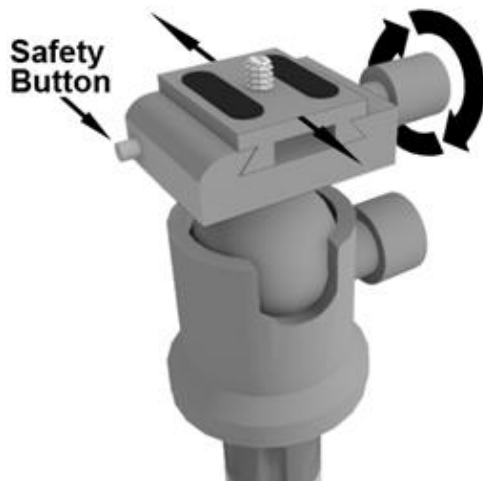

To remove the quick release plate, turn the quick release knob counter clockwise until it is fully rotated. Press the silver safety release button, then gently slide the camera plate out. To attach the camera to the quick release plate, hold the camera securely in one hand, and locate the 1/4" screw on bottom of the camera. Secure the screw of the quick release plate onto the camera by turning it clockwise. It is recommended when mounting the camera onto the tripod that the camera is parallel with the Quick Release Plate.

To insert the quick release plate, ascertain that the quick release knob is fully turned counterclockwise, press in the silver safety button, and slide the release plate gently into place. Turn the quick release plate knob clockwise until the plate is secured tightly.

Panning & Tilting

Tilting – To control the resistance of the tilt, you can rotate the ball head adjustment knob clockwise for greater resistance, or counter clockwise for less resistance. Turn the ball head adjustment knob until the desired resistance is achieved. (Note: For portrait shots, there is a slit on the cylinder of the ball head, where you can rotate the ball head into to achieve portrait. For a full 90 degree angle the Quick Release Plate Knob must be facing up.)

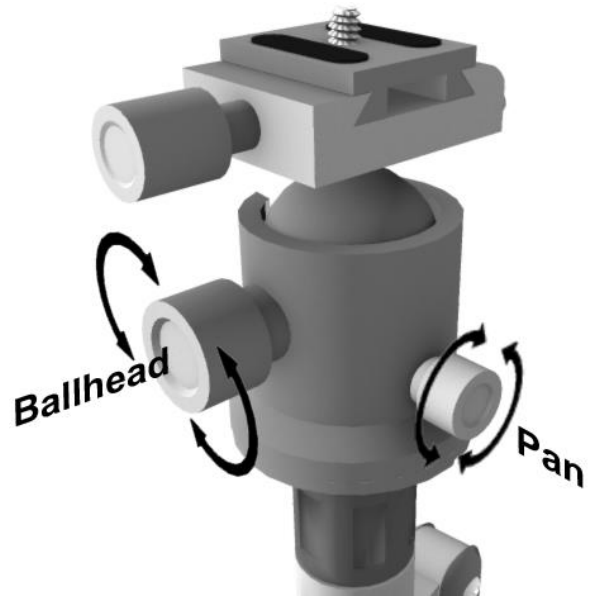

Panning- For smooth consistent panning, tighten or loosen the ball head panning adjustment knob until the right amount of resistance is obtained. Turning the knob clockwise will tighten the head and make panning slow and firmer. Turning the knob counter-clockwise to loosen it will make panning fast and easy. (Note: Finding the right amount of panning resistance will give you smooth and optimal speed for great captures. We also recommend the use of sand bags or carry bags attached to the hook, to provide greater stability when panning.)

Inverted Shooting

There are two methods for inverted shooting. The first method allows the use of the locking legs feature. The second method is quicker and easier to setup but does not allow the legs to lock into positions.

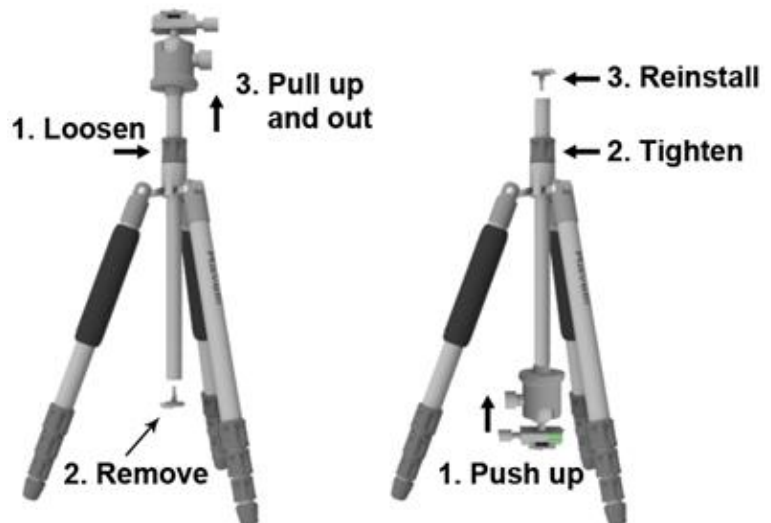

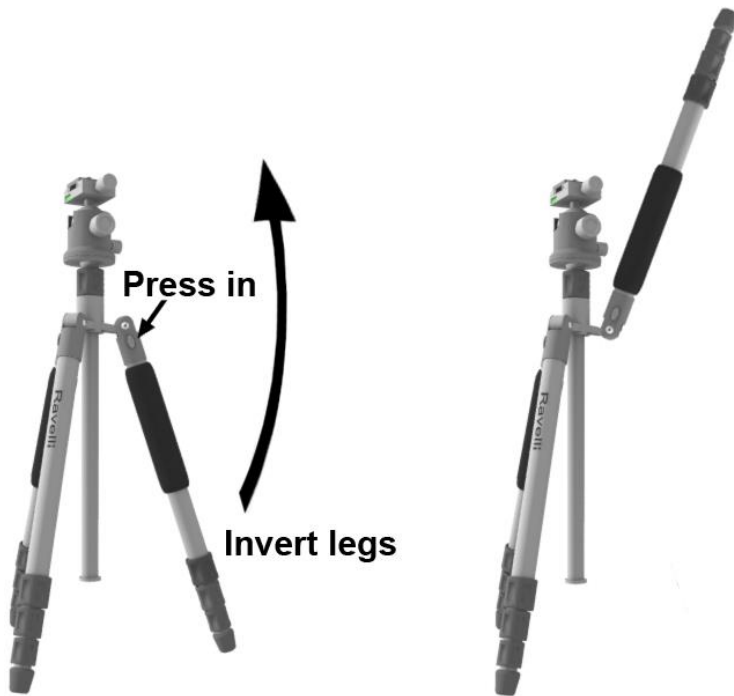

First method- The first method involves removing the center column and inverting it upside down. First, loosen the center column height adjustment lock knob. Next, unscrew the accessory hook on the bottom of the center column to remove. Remove the center column by pulling it up and out of the center. Next slide the center column in upside down, making sure to align the slit on the center column with the tab inside the center column shaft hole. You may have to rotate the column until you feel the tab align

properly with the center column indentation. Adjust the shaft until the right height is achieved then retighten the center column height adjustment knob to secure. You may reattach the accessory hook on the top to prevent loss. Reverse the process to use the

Second method- For the second method, start by loosening the center column height adjustment knob and pull the center column up until it is fully extended, then tighten the knob to secure it in place. Next, invert the legs by pressing in the grey button leg locks and rotate the legs all the way around to the opposite angle. Follow these steps for all three legs then turn your tripod upside down.

How to remove the head of the Tripod

To remove the ball head from the legs, first ensure the pan adjustment knob is fully tightened. Next, grasp the ball head with one hand and the tripod legs with the other and rotate the ball head counter clockwise to unscrew it from the legs. To reinstall, simply attach the ball head by mounting it on the

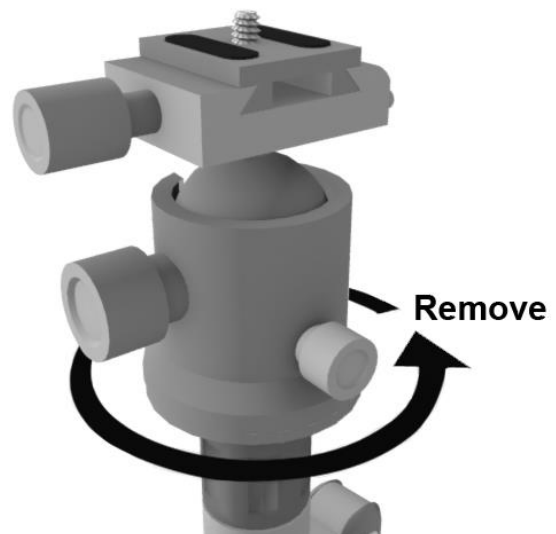

3/8" screw then rotate it clockwise until it is fully seated on the center column.

Storage

Invert the legs using one of the methods above. Store the tripod in the carry case provided to protect against damage from the elements.

Applying weight to increase tripod stability

The tripod is designed with a special spring loaded hook located at the bottom of the center column. By attaching weight on the hook, the stability of the tripod can be increased for sharper images. The weight can be in the form of a sandbag, accessory bag, camera bag, etc.

Care & Maintenance

Clean the tripod with a damp cloth.

Leg maintenance: In the event that sand or dirt gets stuck in the tripod, the leg may become hard to extend and retract. This can be rectified by disassembling the legs. Twist the rubber knob of the leg that is stuck counterclockwise, until it detaches from the threads. Be careful as two black tabs may fall out. When done removing any sand, line tabs with the indentions inside the holes at the end of the leg, and insert the leg back into the stand.

Notes:

-Each leg is designed with an Allen bolt. If the legs become loose after long term use, you may adjust the tension on the leg attachment screws/pivot points.

- Always ensure all leg lock knobs, center column knob and ball head knobs are securely tightened before placing the tripod and camera on a firm surface.

-There is a tipping risk for fully extended tripods. This can be due to moving the tripods while fully extended, things such as uneven surfaces or heavy wind. To reduce the risk of tipping over, we recommend placing one tripod leg facing the same direction as the camera or the heavy part of mounted equipment to balance the weight. We also recommend purchasing sand bags or weights to set on the tripod legs to hold the tripod in place. Ravelli™ guarantees the tripod only and is not liable for damage caused to backdrops, cameras, lighting, or any other items

Specifications

Model:	APGL5 Model Tripod
Max Load:	Supports Up To 17 LBS
Panning Angle:	360°
Tilt Angle:	180°, 90° Upward or 90° Downward
Dimensions:	Storage Height: 19" (482 mm) Collapsed Height: 24.5" (622 mm) Maximum Height: 65.75" (1660 mm) Minimum Height: 19" (584mm)(inverted height is 0)
Weight:	Tripod: 3.8 LBS Shipping Weight: 6 LBS
Quick Release Plate Screw:	1/4"
Quick Release Plate Dimensions:	2.1 x 1.3"
Height Leg Locks:	3 Height Adjustment Leg Locks
Feet Materials:	Rubber feet
Unit Materials:	Tripod: 100% High Grade Aluminum Carrying Case: Nylon
Leg Sections	4
Leg Diameter (per segment)	1 st -.90" (22 mm) 2 nd -.78 (19 mm) 3 rd – .66" (16 mm) 4 th — .55"(13 mm)
Foam Grip Handles	2
Ball head	1.06" (26 mm)

Optional* Ravelli ATD Tripod Dolly



*Dolly not included with tripod.

***Optional ATD Tripod Dolly: To easily maneuver your tripod or stands, we recommend our universal heavy duty Ravelli ATD Tripod Dolly. The ATD dolly is an excellent choice for use with your professional background stands, light stands, and also video and camera tripods. This dolly offers smooth movement with 3" rubber wheels and metal ball bearings. The Ravelli ATD also includes a one-step lock on each wheel to securely hold your tripod in place. The dolly is easily folded and has a carrying handle built in and includes a protective bag.