

# Ravelli

ABSL Model Background Stand



## Product Overview:

The completely redesigned Ravelli ABSL model background stand is 12.4' tall by 15' wide. It is comprised of two tripod stands and five 3' cross bar sections and includes a heavy duty carry bag. The new ABSL stand includes several key product features which are significant improvements over previous versions as well as most other stands available in the market. First, the cross bar interconnects have been lengthened from 3.2" to 6". The stability of the cross bar is dependent largely on the length of the interconnect pieces between section. At 6" we believe these are the longest interconnect pieces available which significantly increases the stability of the crossbar for use with even the heaviest canvas backdrops. Second, The tripod stands have been redesigned with air cushioned shocks - a change from the previous metal spring shocks. The air cushion shock system extends the entire height of the stand allowing the fully extended stands to steadily and safely collapse to their minimum height. Stands which utilize a metal spring at the bottom, allow the stands to collapse approximately 80% of the extension before hitting the metal spring. Under a heavy load this can cause the stand to collapse quite quickly and "bounce" on the metal spring which can be unsafe and even cause your stand to fall over. Third, the material on the stand bag has been upgraded from 840D (denier) weight to 1680D weight and the zipper has been upgraded from a 4mm plastic zipper to an 8mm white copper zipper. The 1680D material is very thick and durable and together with the larger metal zipper should stand up to years of heavy use. Other product improvements include ergonomic tension screws, individual elastic straps for each cross bar sections in the bag, and end caps for the crossbar to prevent tearing of your backdrops. Also included is a reversible male studio spigot adapter which allows the use of photographic equipment with 3/8" or 1/4" threads. The adapter is also machined with two indentions to securely mount your light kits.

## Key Features:

- Full Size 12.4'x15'
- 6" Crossbar Interconnects
- Molded Aluminum Construction
- Air Cushion Stands
- 1680D Ballistic Nylon Bag
- Heavy Duty 8mm White Copper Zipper
- Large Ergonomic Lock Knobs
- Doubled Boxed Shipping
- Male Studio Spigot Reversible Adapter
- English Manual

**Parts List:**

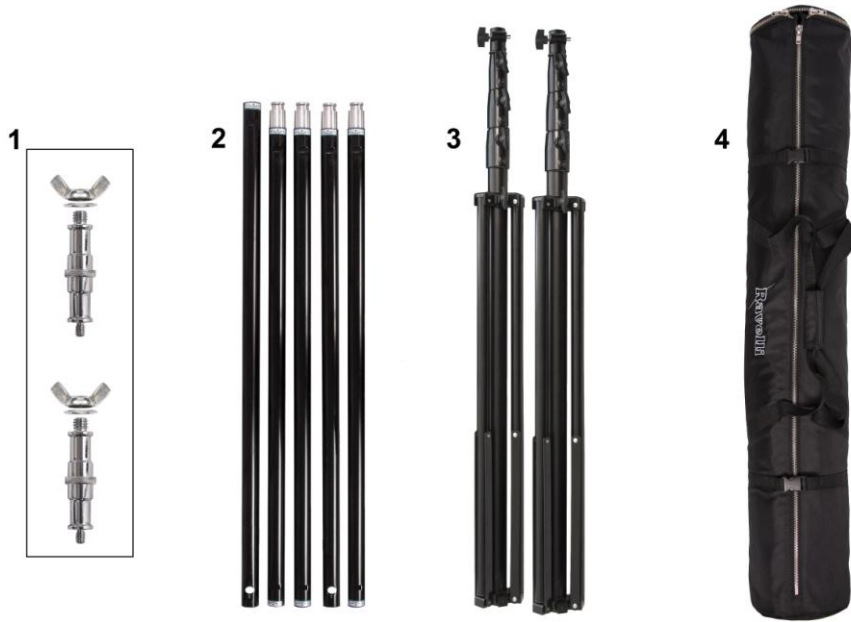

Part	Description	Quantity
1	Male Studio Spigot Reversible Adapter, Washer, Wing Nut	2
2	3.3' Cross Bar	5
3	ABSL Background Tripod	2
4	1680D Ballistic Nylon Bag	1

**Specifications:**

Model:	ABSL
Variable Widths:	2 Poles: 6' (approx) 3 Poles: 9' (approx) 4 Poles: 12' (approx) 5 poles 15' (approx)
Unit Height:	Collapsed: 3' 9 1/2" Extended: 12.4'
Unit Weight	21.7 LBS
Shock Absorbers:	Full Length Air Shocks
Unit Materials:	Tripods and Extension Poles: 100% High Grade 30mm Diameter 1.1mm Thick Aluminum Adjustment Knobs: Polyurethane Carrying Case: 1680D Ballistic Nylon
Total Footprint:	48" Diameter, 41" foot leg to foot leg
Height Set Screws	3 Height Adjustment Set Screws

## Set Up Instructions:

**1. Setting up the tripods:** Upon removing the tripods from the bag all knobs will be tightened. To set up the tripod, you will first need to loosen the set screw on the leg brace. Pull the legs outward from the center pole and then you will be able to push in a downward motion on the top of the brace while holding the center pole (See Figure 1). Continue pushing downward until the legs are fully extended. Once the legs are fully extended, you will need to tighten the set screw to secure the legs into position.

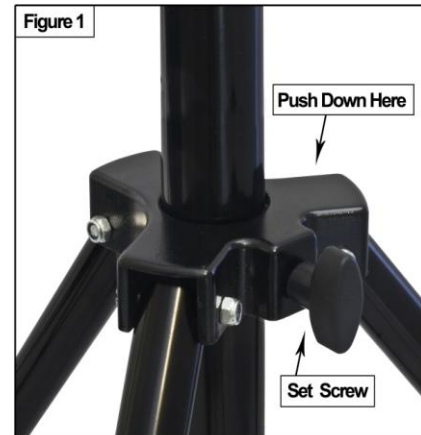

**2. Setting up the extension poles:** Your background stand comes with five 3' cross bars. The poles have been designed with a male and a female end on each bar resulting in a slide and lock design (See Figure 2). Simply slide the silver male end into one of the female ends. Once fully inserted, turn the poles approximately 90 degrees until you feel a lock and the arrows on the stickers are aligned with each other.

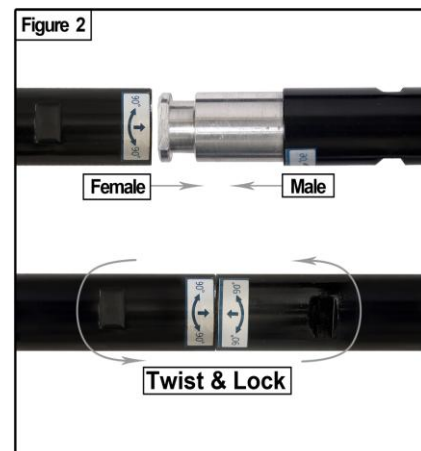

**3. Attaching crossbars to the tripods:** Each one of the tripods has a reversible adapter on the top with a washer and a wing nut already attached. To attach the cross bars to the tripods, simply unscrew and remove the wing nut and the washer. On the cross bar there is a hole on one side of the pole. Simply slide the pole onto the screw, slide on the washer, then screw on the wing nut and tighten until secure (See Figure 3).

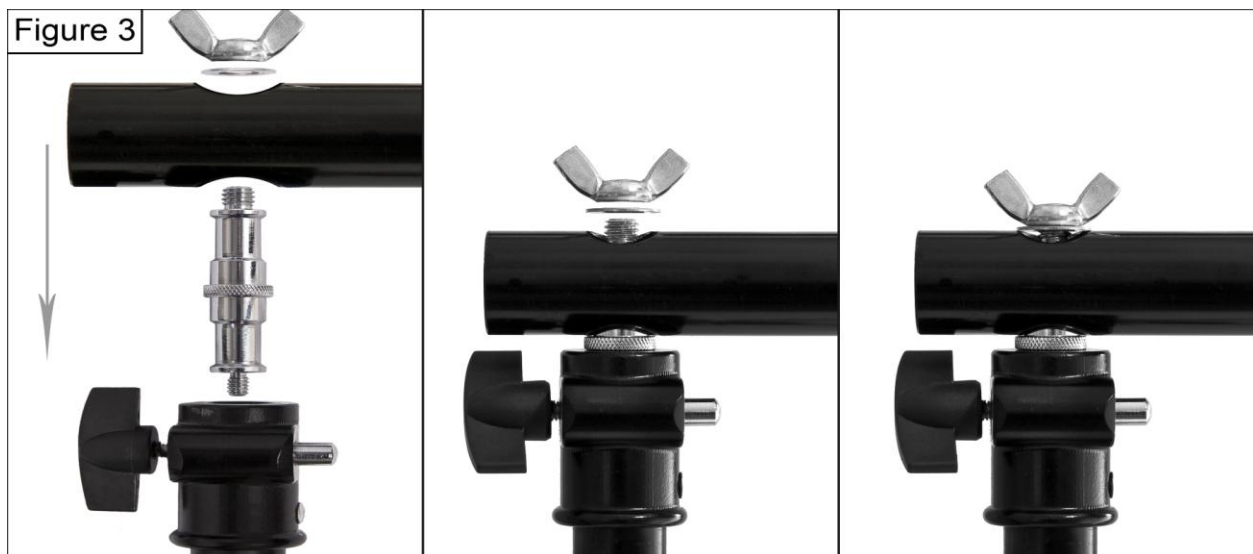

**Note:** The crossbars can be set at various lengths. The minimum length would be the use of two crossbars. To do so, you will have to use the two cross bars that have the holes on either end so that they can be attached to the tripod stands.

**4. Adjusting the height of your tripods:** Each one of your tripod stands are adjustable in height up to 12.4 feet. To adjust the height, simply loosen the top set screw, and then pull in an upward motion up to the desired height. To achieve full extension it is recommended that you first loosen the top set screw and fully extend the top section of the tripod. Once fully extended, tighten up the top set screw and repeat this process with the middle and bottom section (See Figure 4).

**5. Reversible adapter:** The tripod stands include a male studio spigot adapter which is used for various lighting and photographic equipment. The adapter has 3/8" and 1/4" screw threads and also has been precision machined to securely mount strobe lights. The adapter locks into place using a push button and set screw. To remove the adapter, simply loosen the set screw, press the button in and pull the adapter up (See figure 5).

**Optional ATD Tripod Dolly\*:** To easily maneuver your tripod stands, we recommend our universal heavy duty Ravelli ATD Tripod Dolly. The ATD dolly is an excellent choice for use with your professional background stands, light stands, and also video and camera tripods. These dollies offer smooth movement with 3" rubber wheels and metal ball bearings. The Ravelli ATD also includes a one-step lock on each wheel to securely hold your tripod in place. The dolly is easily folded and has a carrying handle built in and includes a protective bag.



\*Dolly not included with background stands

**Notice:** Once your background stand is set up please be aware that some sag in the cross bars can be a common issue based on the size and weight of the backdrop you are using.

**WARNING:** There is a tipping risk for the fully extended tripods or tripods and crossbar. This can be due to moving the tripods while fully extended, a model or photographer stepping on a backdrop, heavy mounted equipment such as strobe lights, or even things such as uneven surfaces or wind. To reduce the risk of tipping over, we recommend placing one tripod leg facing the same direction as the backdrop or in the same direction as the heavy part of mounted equipment to balance the weight. We also recommend purchasing sand bags or weights to set on the tripod legs to hold the stands in place. Ravelli™ guarantees the stand only and is not liable for damage caused to backdrops, cameras, lighting, or any other items.