

# RAVELLI

APGL5 Model Tripod



[www.Ravellipho.com](http://www.Ravellipho.com)

## **Product Overview**

The Ravelli APGL5 is a Professional Quality Tripod providing a solid base for photographic equipment. It is made from Aluminum to create a light weight and sturdy tripod. The ball head provides smooth adjustments to any angle. The center column is gearless and the legs can be inverted for low angle shots or compact storage.

## **Features**

- Head
  - Quick Release Plate With Safety Locking Button
  - Detachable Video Handle
  - Professional Detachable Metal Ball Head
  - Smooth Pan & Tilt Dampened Motion
- Legs
  - 2 Step Locking Positions
  - Legs can be used as Monopods
  - Quick Twist Leg Lock Height Adjustments
  - Padded Foam Grips On Two Of The Legs To Safely Grab and Transport Your Tripod
  - Non-Slip Rubber Feet For a Stable Tripod
  - Built in Retractable Spikes
- Other
  - Compact and Light, Yet Still Supports Cameras Up To 6 LBS
  - Height Adjustable Center Column
  - Accessory hook

# Identifying the parts



- A Quick Release Plate
- B Quick Release Plate Lever
- C Ballhead Rotation Knob
- D Ballhead Adjustment Handle
- E Center Column Height Adjustment Lock
- F Push Button Leg Locks
- G 2 Piece Center Column
- H Foam Handle Grips
- I Height Adjustment Twist Leg Locks
- J Accessory Hook
- K Rubber Feet/Retractable Spikes

## Initial Set UP

To begin using the tripod, open the carrying bag using the zipper and pull the tripod out of the protective bag. The tripod is stored in the inverted position. Invert each leg and adjust the center column.

## Height Adjustment

Adjusting the height of the Tripod can be done by simply twisting the rubber knobs located on the legs, clockwise to lock or counter-clockwise to unlock. Then extend the legs down to the desired height, and relock the rubber knobs. *(Note: When adjusting height, try to extend the thicker leg segment, as they are thicker and provide greater stability.)*

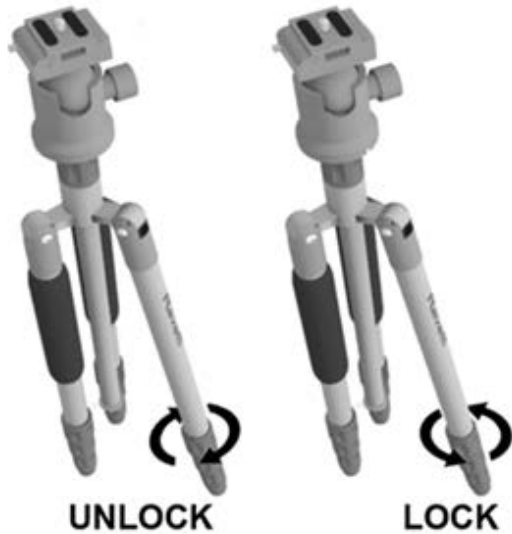

If after you have fully extended the legs, you have still not reached the maximum operating height, you may adjust the center column up.

**Quick Tip:** You can unlock all segments on each leg at once by grabbing them at the same time and then twisting counter clockwise to unlock. Extend the legs then lock each knob. To quickly retract the legs when they are extended, unlock each knob on one leg starting with the thicker portion of the leg, retract the leg then tighten all knobs with one hand turning clockwise.

## The Quick Release Plate



To remove the quick release plate, pull the quick release lever outwards until it is fully extended. Press the safety release button, then gently slide the camera plate out.

To attach the camera to the quick release plate, hold the camera securely in one hand, and locate the 1/4" screw on bottom of the camera. Secure the screw of the quick release plate onto the camera by

turning it clockwise. It is recommended when mounting the camera onto the tripod that the camera is parallel with the Quick Release Plate.

To insert the quick release plate, ascertain that the quick release lever is fully unlocked, press in the safety button, and slide the release plate gently into place. Close the quick release plate lever until the plate is secured.

## Panning & Tilting

The tripod comes with a knob and a handle for your preference to control the ballhead.

**Tilting** – To control the resistance of the tilt, you can rotate the ball head adjustment knob/handle clockwise for greater resistance, or counter clockwise for less resistance. Turn the ball head adjustment knob/handle until the desired resistance is achieved. *(Note: For portrait shots, there is a slit on the cylinder of the ball head, where you can rotate the ball head into to achieve portrait mode.*

**Panning**- For smooth consistent panning, tighten or loosen the ball head panning adjustment knob until the right amount of resistance is obtained. Turning the knob clockwise will tighten the head and make panning slow and firmer. Turning the knob counter-clockwise to loosen it will make panning fast and easy. *(Note: Finding the right amount of panning resistance will give*

*you smooth and optimal speed for great captures. We also recommend the use of sand bags or carry bags attached to the hook, to provide greater stability when panning.)*

## **Low Angle Shooting**

The tripod is designed with 2 piece center column which allows it to be shortened for low angle shots. To make it shorter, first make sure the center column lock knob is fully tightened to prevent it from turning, next grab the lower portion of the center column then rotate it counter clockwise until it completely unscrews. Now you may spread out the legs until you achieve the low height needed.

## **Inverted Shooting**

There also are two methods for inverted shooting. The first method allows the use of the locking legs feature. The second method is quicker and easier to setup but does not allow the legs to lock into positions.

First method- The first method involves removing the center column and inverting it upside down. First, loosen the center column height adjustment lock knob. Next, unscrew the accessory hook on the bottom of the center column to remove. Remove the center column by pulling it up and out of the center. Next slide the center column in upside down, making sure to align the slit on the center column with the tab inside the center column shaft hole. You may have to rotate the column until you feel the tab align properly with the center column indentation. Adjust the shaft until the right height is achieved then retighten the center column height adjustment knob to secure. You may reattach the accessory hook on the top to prevent loss. Reverse the process to use the

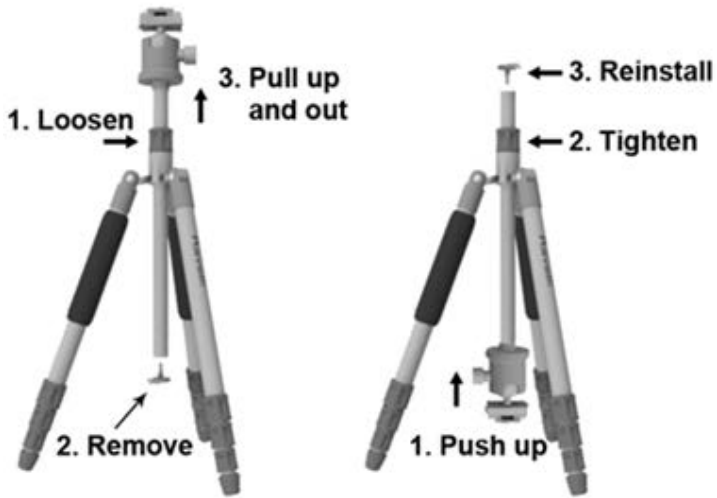

Second method- For the second method, start by loosening the center column height adjustment knob and pull the center column up until it is fully extended, then tighten the knob to secure it in place. Next, invert the legs by pressing in the grey button leg locks and rotate the legs all the way around to the opposite angle. Follow these steps for all three legs then turn your tripod upside down.

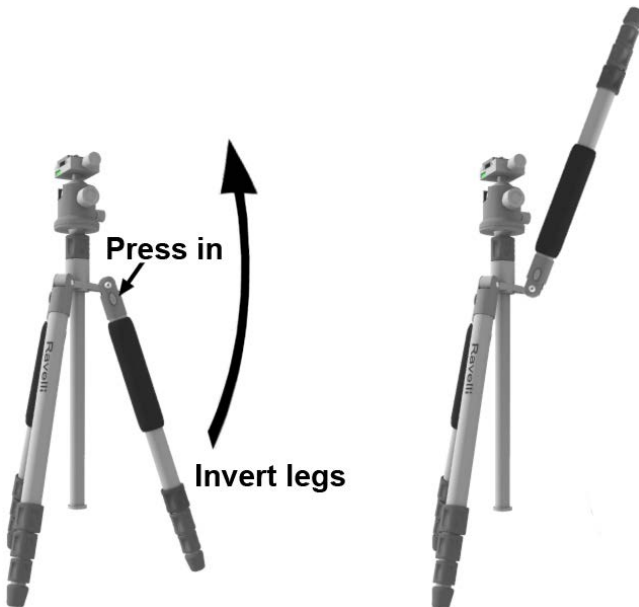

## **Monopod**

Each leg can be used a monopod if needed. To use this feature grasp one leg with one hand and hold the tripod with the other, simply unscrew the leg from the stem by turning it counter clockwise until it detaches. Now you may remove the ball head and attached it to the top of the leg to use it as a monopod.

## **How to remove the head of the Tripod**

To remove the ball head from the legs, first ensure the pan adjustment knob is fully tightened. Next, grasp the ball head with one hand and the tripod legs with the other and rotate the ball head counter clockwise to unscrew it from the legs. To reinstall, simply attach the ball head by mounting it on the 3/8" screw then rotate it clockwise until it is fully seated on the center column.

## **Storage**

Invert the legs using one of the methods above. Store the tripod in the carry case provided to protect against damage from the elements.

## **Applying weight to increase tripod stability**

The tripod is designed with a special spring loaded hook located at the bottom of the center column. By attaching weight on the hook, the stability of the tripod can be increased for sharper images. The weight can be in the form of a sandbag, accessory bag, camera bag, etc.



## **Care & Maintenance**

Clean the tripod with a damp cloth.

-Each leg is designed with an Allen bolt. If the legs become loose after long term use, you may adjust the tension on the leg attachment screws/pivot points.

Leg maintenance: In the event that sand or dirt gets stuck in the tripod, the leg may become hard to extend and retract. This can be rectified by disassembling the legs. Twist the rubber knob of the leg that is stuck counterclockwise, until it detaches from the threads. Be careful as two tabs may fall out. When done removing any sand, line tabs with the indentions inside the holes at the end of the leg, and insert the leg back into the stand.

### **Notes:**

- Always ensure all leg lock knobs, center column knob and ball head knobs are securely tightened before placing the tripod and camera on a firm surface.

-There is a tipping risk for fully extended tripods. This can be due to moving the tripods while fully extended, things such as uneven surfaces or heavy wind. To reduce the risk of tipping over, we recommend placing one tripod leg facing the same direction as the camera or the heavy part of mounted equipment to balance the weight. We also recommend purchasing sand bags or weights to set on the tripod legs to hold the tripod in place. Ravelli™ guarantees the tripod only and is not liable for damage caused to backdrops, cameras, lighting, or any other items

## **Specifications**

Model:	APGL5 Model Tripod
Max Load:	Supports Up To 6LBS
Panning Angle:	360°
Tilt Angle:	180° , 90° Upward or 90° Downward
Dimensions:	Storage Height: 20.5" Collapsed Height: 23.5" Maximum Height: 65" Minimum Height: 7" (inverted height is 0")
Weight:	Tripod: 3.1 LBS
Quick Release Plate Screw:	1/4"
Leg Locks:	3 Rotating Height Adjustment Leg Locks
Feet Materials:	Rubber feet / Metal Spikes
Unit Materials:	Tripod: 100% High Grade Aluminum Carrying Case: Nylon
Leg Sections	4

## Optional\* Ravelli ATD Tripod Dolly



\*Dolly not included with tripod.

\*\*\*Optional ATD Tripod Dolly: To easily maneuver your tripod or stands, we recommend our universal heavy duty Ravelli ATD Tripod Dolly. The ATD dolly is an excellent choice for use with your professional background stands, light stands, and also video and camera tripods. This dolly offers smooth movement with 3" rubber wheels and metal ball bearings. The Ravelli ATD also includes a one-step lock on each wheel to securely hold your tripod in place. The dolly is easily folded and has a carrying handle built in and includes a protective bag.